

# 2021 TARIFFS



## Editorial

At Yelloh! Village Le Sérignan Plage like every Yelloh! Village, our quality facilities are guaranteed to be open from the start of the season right to the end.

From day one the pools are heated, the entertainment activities and mini-club are up and running. All entertainment is free, as is the access to the Lagon and Indoor Swimming Pool (please refer to the access conditions for Balnéo Spa area).

We hope to see you very soon at Yelloh! Village.

Catherine & Jean-Guy Amat and their team.

P.S. This year we will be open **from April 23<sup>th</sup> to September 27<sup>th</sup> 2021** for you to take full advantage of September's Indian summer!



## We welcome babies and children



Three multi-lingual clubs are free of charge with recreational, craft and sporting activities) for 4-7 year-olds, 8-12 year-olds and 13-17 year-olds.

Access to the "Toddler play house" is free (0-4 years).

**Babies (under 3 years)** can stay in the camping pitches **free of charge** for the whole season and children (3-6 years) can stay free of charge from 23/04 to 02/07/2021 and from 29/08 to 27/09/21.

Adapted equipment: travel cot and high chair in every rental.



## BALNEO : Special Offer

In April, May, June & September clients have free access to the Balnéo Spa. In July and August, an access pass entitles 2 persons per pitch or accommodation to enjoy the Balnéo Spa at the same time. This pass is free of charge.

*The Balnéo access is limited to over 16-year olds. We deliver an access pass during the high season to preserve this area dedicated to peace and tranquility. Mornings are reserved for naturists, whereas swimsuits are required for the afternoons (Strictly no shorts).*



### Spa & Balneo

**Mediterranean Ritual 99 € includes:**

1 body scrub, 1 relaxing body massage, 1 facial treatment.

**Vitality Ritual 195€: Includes:**

1 back massage, 1 Kansu massage, 1 facial, 1 energy massage.



## DISCOVER LANGUEDOC PASS\*



Discover the Languedoc pass. For all 7 night (minimum) stays in rental accommodation during April, May, June & September.

Offering access to 3 activities per person, choose from a long list, free of charge + 1 massage/ nail /face care treatment to be used in the Wellness centre for 1 person.

Available for 95 € during July and August.

\* Offer cannot be used in conjunction with others and are subject to availability.



## Sunshine Guarantee

During June and from 5 September 2021, if it isn't particularly sunny and it rains, you may cut short your holiday if you have booked in advance a minimum of 1 week's holiday. You will then only pay for the nights used. Rest assured, the weather is always good in the south of France!



# CAMPING Caravanning



PRICES PER NIGHT, IN EUROS. TOURIST TAX NOT INCLUDED (FROM AGE OF 18).  
FREE CHOICE OF ARRIVAL DATE FOR ALL PITCHES, SUBJECT TO AVAILABILITY.



DATE	CAMPING CARAVANNING						
FROM - TO	PHARE OUEST PACKAGE 1 OR 2 PERSONS **	PLAGE PACKAGE 1 OR 2 PERSONS **	PHARE OUEST OR PLAGE PACKAGE 1 OR 2 PERSONS ***	ADDITIO -NAL PERSON	CHIL- DREN 3 TO 6 YEARS OLD	CHIL- DREN - 3 YEARS OLD	PET
23/04 - 11/05	21	23	26	7	0	0	6
12/05 - 16/05	24	26	29	7	0	0	6
17/05 - 20/05	21	23	26	7	0	0	6
21/05 - 18/06	35	37	40	7	0	0	6
19/06 - 25/06	39	41	44	7	0	0	6
26/06 - 02/07	43	45	51	7	0	0	6
03/07 - 09/07	60	62	68	9	7	0	6
10/07 - 16/07	64	66	72	9	7	0	6
17/07 - 30/07	68	70	76	9	7	0	6
31/07 - 14/08	71	73	79	9	7	0	6
15/08 - 21/08	64	66	72	9	7	0	6
22/08 - 28/08	50	52	58	9	7	0	6
29/08 - 04/09	35	37	40	7	0	0	6
05/09 - 11/09	26	28	31	7	0	0	6
12/09 - 27/09	22	24	27	7	0	0	6

Camping caravanning: pitches are available from noon and should be vacated before noon on departure date. 10 amp electricity included. 1 car.

Only gas barbecues and gas planchas are allowed.

Pets must be kept on a lead, must have a valid health record and are prohibited on the beach, in swimming pool areas, in shops, and other buildings. 1<sup>st</sup> and 2<sup>nd</sup> category dogs (please refer to French legislation) are prohibited on site.

SECTOR	ELEC. 10 A	WATER	SIZE (M²)
Phare Ouest **	10 A	at proximity	100
Plage **	10 A	at proximity	of 80 at 100
Phare Ouest ***	10 A	Connec- tion And eva- cuation	of 100 at 130
Plage ***	10 A	Connec- tion And eva- cuation	100

## WEEKEND accommodations

BOOKINGS POSSIBLE 90 DAYS BEFORE THE ANTICIPATED ARRIVAL DATE - TOURIST TAX NOT INCLUDED ( FROM 18 YEARS OLD )

Weekend package, 1 or 2 nights, arrival on Friday or Saturday for departure Sunday or Monday.								
DATE	TENT	COTTAGE AND CHALET					CABANE	
TARIFFS FOR THE WEEKEND OF	TENTE SÉOUNE 5 P. TENNIS 4 P. 2 BDRMS. **	LANGUEDOC 4/6 P. 2 BDRMS. **	OCCITANIE 4/6 P. 2 BDR. ***	OCCITANIE 6 P. 3 BDR. ***	WHEELCHAIR FRIENDLY 4 P. - 2 BDR *** CHALET ORPELLIÈRE COTTAGE BALNEO 5 P. - 2 BDR. *****	LAGON PATIO 7 P. 3 BDRMS. ****	PÊCHEUR 4 P. JARDIN 4 P. ROBINSON 5 P. 2 BDRMS. PREMIUM	PÊCHEUR JARDIN CANARDIÈRE 6 P. 3 BDRMS. PREMIUM
24/04	-	138	149	159	186	205	235	267
01/05 and 08/05	-	138	149	159	186	205	235	267
29/05	238	238	257	275	308	338	394	429
05/06	238	238	257	275	308	338	394	429
12/06	238	238	257	275	308	338	394	429
19/06	247	247	271	294	328	360	419	466
26/06	309	309	339	367	416	468	528	586
03/07	413	413	446	493	559	626	686	752
04/09	235	235	267	297	335	378	410	448
11/09	151	151	176	192	213	248	281	319
18/09 and 25/09	-	138	151	165	176	205	243	281
Bank-Holiday weekend package								
ASCENSION from 12/05 to 17/05	3 nights	326	326	352	377	422	463	540
	4 nights	370	370	399	428	479	525	613
PENTECÔTE from 21/05 to 25/05	2 nights	238	238	257	275	308	338	394
	3 nights	282	282	304	326	365	400	467

# RENTAL Accommodation



PRICES PER NIGHT, IN EUROS. TOURIST TAX NOT INCLUDED (FROM AGE OF 18).

FREE CHOICE OF ARRIVAL DATE FOR ALL PITCHES, SUBJECT TO AVAILABILITY.



## Weekly & short break rates (excluding weekends)

DATE	TENT	COTTAGE AND CHALET					CABANE	
FROM - TO	TENTE SÉOUNE 5 P. TENNIS 4 P. 2 BDRMS. **	LANGUEDOC 4/6 P. 2 BDRMS. **	OCCITANIE 4/6 P. 2 BDRMS. ***	OCCITANIE 6 P. 3 BDRMS. ***	WHEELCHAIR FRIENDLY 4 P. - 2 BDR. *** CHALET ORPELLIERE COTTAGE BALNEO 5 P. - 2 BDR. *****	LAGON PATIO 7 P. 3 BDRMS. *****	ÊCHEUR 4 P. JARDIN 4 P. ROBINSON 5 P. 2 BDRMS. PREMIUM	PÊCHEUR JARDIN CANARDIERE 6 P. 3 BDRMS. PREMIUM
23/04 - 11/05	-	51	55	59	69	76	87	99
12/05 - 16/05	88	88	95	102	114	125	146	159
17/05 - 20/05	47	47	51	56	65	72	83	96
21/05 - 18/06	88	88	95	102	114	125	146	159
19/06 - 25/06	95	95	106	116	129	142	164	186
26/06 - 02/07	134	134	145	156	179	205	227	248
03/07 - 09/07	172	172	185	209	235	259	281	309
10/07 - 16/07	186	186	201	231	259	283	307	335
17/07 - 23/07	189	189	210	237	267	291	311	338
24/07 - 14/08	206	206	233	261	292	316	336	365
15/08 - 21/08	190	190	215	242	269	291	310	338
22/08 - 28/08	145	145	161	174	195	215	238	265
29/08 - 04/09	87	87	99	110	124	140	152	166
05/09 - 11/09	56	56	65	71	79	92	104	118
12/09 - 27/09	-	51	56	61	65	76	90	104

Rental accommodation stays, with assigned parking, are defined as arrival at 5pm to departure at 10am. for a minimum of 7 nights. For short breaks: contact the holiday village directly.

Deposit: 200 € (creditcard, visa or mastercard). Cleaning fee when the

accommodation is left unclean: 80 €.

Sheets not included in the price, available to hire (12 €/bed/change of bedding) except for the Tents Séoune, Tents Tennis, Cottage \*\*\*\* and Cabanes PREMIUM in which bed linen and hand towels for bathroom use are included.

No tents allowed on accommodation pitches. Only gas barbecues and gas planchas are allowed. Smoking is prohibited in all accommodation units. Animals are prohibited in rental accommodation.



## SPECIAL OFFERS

### -10% EARLY BOOKING\*

for bookings made before 31/12/2020 for stays from opening date until 02/07/2021 and from 04/09/2021 to closing date.

( PREMIUM accomodation not included )

### -10% FOR LONG STAYS\*

-10% for any booking of a minimum of 21 nights, from opening date until 02/07/2021 and from 04/09/2021 to closing date.

\* offers cannot be used in conjunction with other offers and are subject to conditions & availability.

ACCOMMODATION EQUIPMENT	TENT SÉOUNE **	TENT TENNIS **	COTTAGE LANGUEDOC ** OCCITANIE ***	CHALET ORPELLIÈRE COTTAGE BALNÉO LAGON AND PATIO ****	CABANE PREM1UM
<b>OUTSIDE</b>					
Terrace	•	•	•	Covered	Covered
Garden furniture			•	•	•
Bar table + stools	•	•			
2 Sun loungers			•	•	Pêcheur Jardin
Hammock	•	•			Canardière Robinson
2 Lounge chairs	•	•			Canardière
Plancha					Canardière
2 Bikes one with child seat	•	•		•	•
Situated in landscaped areas car free zone				•	•
<b>BEDROOM(S)</b>					
Blanket and pillow per bed	•	•	•	•	•
Sheets provided	•	•		•	•
Twin beds include one pullout bed				Balnéo and Patio	•
Queen-size bed 160x200	•	•		Balnéo and Patio	•
High density «Bultex»					
<b>KITCHEN / LIVINGROOM</b>					
Electric hob or gas	•	•	•	•	•
Crockery	•	•	•	•	•
Fridge	•	•	•	•	•
Freezer			•	•	•
Sink	cold water	cold water	•	•	•
Electric coffee machine	•	•	•	•	•
Microwave			•	•	•
Kettle				•	•
Toaster				•	•
Dishwasher				•	•
Heating			•		
Air conditioning (warm and cold)			only occitanie	•	•
TV					•
<b>BATHROOM / WC</b>					
Shower and washbasin			•	•	•
Separate WC		•	•	•	•
Towels provided	•	•		•	•
Hairdryer				•	•
<b>FACILITIES AND SERVICES</b>					
Travelcot	•	•	•	•	•
Highchair	•	•	•	•	•
Safety deposit box			•	•	•
End-of-stay cleaning included					•
Wifi access included					•

### COTTAGE LANGUEDOC \*\* AND OCCITANIE \*\*\*



4/6 persons 30+10 m² - 2 bdrms

Situated in a quiet and shady area, with a sofa bed to accommodate up to 6 people. The Occitanie features reversible air-conditioning.

### COTTAGE OCCITANIE \*\*\*



6 persons 34+10 m² - 3 bdrms

This recent accommodation is situated in a quiet and shady area. Features reversible air-conditioning & parking space within 200 m.

### CHALET ORPELLIÈRE \*\*\*\*



5 persons 32+8 m² - 2 bdrms

Situated in a shady car free area, this chalet has air conditioning and a contemporary interior design.

### TENTE SÉOUNE \*\*



5 persons 25+15m² - 2 bdrms

A charming tent, set up next to a natural zone, for a comfortable holiday.

### TENTE TENNIS \*\*



4 persons 27+16m² - 2 bdrms

A charming tent, set up next to a natural zone, for a comfortable holiday.

### COTTAGE BALNÉO \*\*\*\*



5 persons 27+9 m² - 2 bdrms

This accommodation with air conditioning situated close to the Balneo in a car free area.



### COTTAGE LAGON \*\*\*\*



7 persons 33+19 m<sup>2</sup> - 3 bdrms

This new air conditioned accommodation is situated in a car free zone near the Lagon area.

### COTTAGE PATIO \*\*\*\*

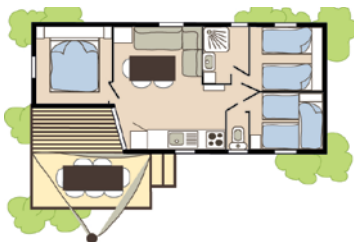

7 persons 33+14 m<sup>2</sup> - 3 bdrms

This accommodation with air conditioning is situated in a shady car-free area in the centre of the campsite.

### COTTAGE WHEELCHAIR FRIENDLY \*\*\*\*



4 pers. - 2 bdrms

This Cottage is suitable for disabled persons. Specially designed for easy access and space to move around in a wheelchair. Contrasting equipment and accessories facilitate visual recognition.

More detailed information on our website.

## THE Cabanes PREMIUM

ACCOMMODATION WITH SEMI-COVERED TERRACE SITUATED IN LANDSCAPED AREAS WHERE CARS ARE PROHIBITED. THESE MODELS HAVE BEEN CREATED WITH PARTICULAR ATTENTION TO INTERIOR DESIGN AND FINISH. AS AN ADDED BONUS, THIS ACCOMMODATION HAS AIR CONDITIONING, REINFORCED ISOLATION AND A SERIES OF ADDITIONAL FEATURES.

### CABANE ROBINSON



5 pers. 37+12 m<sup>2</sup>  
2 bedrooms

Spacious chalet situated close to the Lagoon pool and the water playground with large living room/kitchen and TV satellite. 12m<sup>2</sup> covered terrace with a hammock and 2 deck chairs.

### CABANE CANARDIÈRE



6 pers. 40+22 m<sup>2</sup>  
3 bedrooms

Situated close to a natural zone, this accommodation offers a satellite LCD TV. The 22 m<sup>2</sup> spacious terrace with a plancha and 2 lounge chairs is partially covered by a 8 m<sup>2</sup> pergola.

### CABANE PÊCHEUR ET JARDIN



4 pers. 33+16 m<sup>2</sup>  
2 bedrooms

Beachside accommodation (less than 250 meters from the beach). Offers also a satellite LCD TV. A large semi-covered terrace of 16 m<sup>2</sup>.

### CABANE PÊCHEUR ET JARDIN



6 pers. 38+20 m<sup>2</sup>  
3 bedrooms

Beachside model (less than 250 metres from the beach). A satellite LCD TV. A large semi-covered terrace of 20 m<sup>2</sup>.



## BOOKING YOUR ACCOMMODATION OR YOUR PITCH CHOICE

- On our website, [www.leserignanplage.com](http://www.leserignanplage.com), for up to date availability and secure payment.
  - Enquire by phone (+33 467 32 35 33), fax (+33 467 32 68 39) or e-mail: [info@leserignanplage.com](mailto:info@leserignanplage.com) for information about our accommodation, pitches and village.
  - During your stay, you have the possibility to book now for next year (ask at the reception desk for the conditions). you will be first served.
- Please feel free to do so by coming to the reception, Mon-Fri.



Cabane Jardin



Cabane Canardiere



## CANCELLATION INSURANCE

Cancellation fees may be covered by cancellation insurance offered in partnership with GRITCHEN, for a fee of:  
**3.3% of the price of the rental price (accommodation and camping pitches).**

Survey of terms:

Before you leave, if one of the events below occurs and you are obliged to cancel your stay, you will be refunded for the amounts paid (subject to documentary evidence):

- Death, accident or serious illness (including Coronavirus), hospitalisation of the insured person, a relative or a close family friend.
- Complications of the pregnancy for the insured person.
- State of pregnancy contraindicating the trip due to the nature of the trip.
- Redundancy / contractual termination.
- Contraindications or consequences of vaccinations.
- Depression, psychological, emotional or mental illness.
- Serious vehicle damage.
- Getting a job.
- Cancellation or change to paid leave.
- Professional transfer.
- Serious damage caused by fire, explosion or water damage.
- Tourist visa refusal.
- Summons: in preparation of adopting a child, as either a witness or jury member or for an organ transplant.
- Natural disasters (according to the Law No. 86-600 of 13 July 1986, as amended).
- Cancellation of one of the persons accompanying the insured person (maximum 9 people).
- Separation (civil partnership or marriage).
- Theft from business or private premises.

Curtailed stay:

During your stay, if one of the events opposite occurs and means you have to curtail your stay, you will be refunded the amount corresponding to the part of your stay that has not taken place and that has already been invoiced by the campsite.

For more details, please refer to the special terms and conditions - cancellation:

<http://yellowhresa.webcamp.fr/cgv/custom/2516/cgvAssuren.pdf>

Cabane Pêcheur



## facebook

To stay in touch with us, follow our news and updates or enjoy the advantages we reserve to our fans:

[www.facebook.com/leserignanplage](https://www.facebook.com/leserignanplage),

click on « I like » and become a « fan ».

# GENERAL SALES CONDITIONS



## BOOKING CONDITIONS

- The reservation becomes effective solely
- 1. with the agreement of the Village
- 2. upon receipt of the deposit
- 3. upon receipt of, either the booking proposal duly completed and signed or after acceptance of the general terms and conditions of sale when booking online.
- The Village is not bound by bookings unless the Village has accepted them. The Village is free to accept or refuse bookings, depending on availability and, in general, depending on any circumstances that are likely to be prejudicial to the execution of the booking.
- The Village offers family holidays in the traditional sense, and the accommodation has been specially designed for this purpose. The Village reserves the right to refuse any booking that might contravene or attempt to pervert this principle.
- Booking of camping pitches or rented accommodation is conducted strictly on a personal basis. Under no circumstances may you sub-let or transfer your reservation without the prior consent of the Village.
- Minors should be accompanied by their parents or legal guardians.
- **The management reserves the right to change your pitch number. Preferences are not guaranteed, unless confirmed in writing by the Village.**

## Camping pitches

- The basic package includes the pitch for the tent, caravan or camper van for one or two persons, access to toilet and residential facilities, electricity (10 amp) and access for one car.
- The pitches can hold a maximum of 6 persons, regardless of age.

## Rental accommodation

- The rental accommodation is fully equipped. The basic package ranges from 4 to 7 places, depending on the type of accommodation, 1 car allowed.
- The Village reserves the right to refuse access to families whose participants are greater than the capacity of the rented accommodation.
- Tents are prohibited on accommodation pitches.
- Smoking is prohibited in all rental accommodation.

## Group bookings

- All bookings made for more than 4 accommodation units by one person or made by different people who know each other and who are travelling together for the same reasons and for the same holiday dates are deemed to be group bookings.
- Accommodation appearing on the commercial Yelloh! Village website is intended exclusively for individual bookings.
- For all group booking requests, you must contact the Village by telephone, email or via the Contact Us section.
- The campsite reserves the right to examine booking requests before accepting or declining them.

## Booking fees

- Reservation fees are free of charge.

## PRICES AND TOURIST TAX

Prices shown are effective for the 2021 season. They correspond to one night and are quoted in euros, including VAT (see the price list for what is included in our prices), but excluding tourist tax, which will be established in spring 2021 by the local town council.

## CONDITIONS OF PAYMENT

- For bookings made more than 30 days before the start of the holiday, a deposit of 15% of the total price of the facilities booked must be paid to the Village at the time of the booking. The balance must be paid within 30 days before the start of the holiday.
- For bookings made less than 30 days before holiday starts, the full amount must be paid at the time of booking.
- Without full payment 30 days before arrival, the management has the right to cancel your booking and to readvertise the rental and to retain the totality of the payments.

## CANCELLATIONS AND ALTERATIONS

### 1. Reservation modifications ( subject to additional charges )

Customers may request for the stay(s) to be modified ( dates and/or accommodation type) which must be made in writing to the campsite (by post or e-mail) a minimum of 30 days before the arrival date, as far as practicable within availability. Defferrals until the following season are not permitted.

-Requests to extend the duration of stay(s) will be processed subject to availability and in accordance with applicable tariffs.

-Requests to reduce the duration of stay(s) are deemed to be partial cancellations and will be subject to the cancellation terms and conditions.

-All deferral requests are considered as a cancellation and will be subject to cancellation terms and conditions. Postponements until the following season are not permitted. If the modification /changes above are not possible, the stay

must be spent as the booking stands or can be cancelled subject to the cancellation terms and conditions.

-Postponement of your arrival dates

In absence of any written notification from you regarding a delay to your arrival date, the pitch or accommodation may be made available for sale again 24 hours after the arrival date specified in the contract and you will lose the benefit of your reservation.

### 2. Unused facilities

In the event of stays which are interrupted or cut short for one of the following reasons

- Border closures.
- Administrative closure of the campsite.
- Customer placed in quarantine on arrival or when he/she returns to home country.
- Travel restricted to a number of kilometres meaning he/she cannot come to the campsite.

A credit note for an amount corresponding to unused nights, valid for two years, will be issued by the campsite. If the customer rejects this credit note, he/she will receive a refund, on request, of the corresponding amount, minus the cost of the cancellation insurance if such a subscription has been taken out. Apart from the reasons stated above, all interrupted or shortened stays (late arrival, early departure) due to the customer will not be subject to refunds or credit note.

### 3. Cancellation by the Village

In the event of cancellation by the Village, the sums paid will be reimbursed in full except in case of force majeure. The cancellation shall not however incur the compensation of damages and interest.

### 4. Cancellation by the customer

Any cancellation of a booking must be made in writing to the Village (letter with recorded delivery):

**A.** In case of cancellation by the customer without subscription to the cancellation insurance.

For one of the following reasons and only up to his/her arrival date:

- Border closures.
- Administrative closure of the campsite.
- Customer placed in quarantine on arrival or when he/she returns to home country.
- Travel restricted to a number of kilometres meaning he/she cannot come to the campsite.

A credit note for an amount corresponding to the total of amounts already paid, valid for two years, will be issued by the campsite. If the customer rejects this credit note, he/she will receive a refund, on request, of the corresponding amount.

For all other reasons :

**- Case 1 -** Cancellation up to 15 days before the start of the stay. The deposit of 15% of the amount of the stay will be kept by the campsite as a cancellation fee. The sums paid\*, with the amount of the deposit subtracted, will be refunded.

**- Case 2 -** Cancellation less than 15 days before your arrival: The deposit of 15% of the amount of the stay will be kept by the campsite as a cancellation fee. A credit note for the sums paid\*, with the amount of the deposit subtracted, will be issued by the campsite. This credit note is non-refundable, non-transferable, limited to the campsite where the stay is cancelled and is valid for two years.

\* If this reservation has been partially or totally paid by a credit note, it will be reimbursed according to the conditions set out in the credit note.

**B.** If campers cancel their bookings having taken out cancellation insurance:

Amounts paid are covered by the guarantee in line with the terms & conditions of cancellation. If the reason is not covered by the cancellation insurance or if the case is rejected by it, the general conditions of sale of paragraph **4.A.** apply and the cost of cancellation insurance will be deducted from the amounts paid in the event of cancellation.

## ABSENCE OF RIGHT TO WITHDRAW

In accordance with article L.221-28 of the French consumer code, Yelloh! Village informs its customers that the sale of accommodation services provided on a specific date, or in line with a specific timeframe, is not subject to provisions regarding the 14 day withdrawal period.

## YOUR STAY

### 1. Arrival

- The reception desk is open from 9am to 7 pm.
- Pitches are available from 12 noon.
- Rental accommodation is available at 5pm. Upon arrival a deposit of 200 € by credit card (VISA or MasterCard) will be required. You will receive an inventory sheet to be verified within 12 hours. Any complaint made after this period shall not be taken into consideration.
- Reception must be informed of any additional visitors or guests. Only guests registered at the time of booking are permitted to stay in the accommodation.

### 2. During your stay:

It is the client's responsibility to be insured; the Village accepts

no responsibility in the event of theft, fire, bad weather, etc, or in the event of any incident concerning the civil responsibility of the client.

All customers must comply with the provisions of the internal regulations.

Each named tenant is responsible for disturbances or nuisance caused by persons staying with or visiting them.

### 3. Departure

On the day of departure specified in your contract.

- Pitches should be vacated before 12 noon.
- Rental accommodation should be vacated before 10 am. The rental accommodation will be inspected. If it is left perfectly clean without any missing or damaged items, the deposit shall be refunded to you. The retention of the deposit does not preclude additional compensation in the event that the costs exceed the amount of the deposit.
- If the rented accommodation has not been cleaned before your departure, a cleaning fee of 80 € will be charged.
- For any delayed departure, an additional day may be charged at the price applicable for that night.

## PETS 2 MAXIMUM

**Pets are forbidden in rental accommodation**, on the beach, in swimming pool areas, in shops, and other buildings. They must be kept on a lead at all times. Dogs of the 1st and 2nd category (please refer to French legislation) are not allowed on the campsite. The vaccination certificates of your pet must be up-to-date.

## DISPUTES

Any possible complaint concerning the non-conformity of the services in relation to the contractual commitments must be notified by post or e-mail to the manager of the Village concerned or to Yelloh! Village within 30 days of the end of the stay.

## IMAGE PRODUCTION RIGHTS

You authorise Yelloh! Village, as well as any person designated by Yelloh! Village, to photograph, record or film you during your Yelloh! Village stay and to use the said images, sounds, videos and recordings on any media (in particular on Yelloh! Village sites or internet pages - including Facebook and Instagram - on Yelloh! Village presentation and promotional materials and on travel or tourist guides). This authorisation applies both to you and to the people staying with you. Its sole purpose is to ensure the promotion and entertainment of the establishments and the Yelloh! Village network and may in no way damage your reputation. This authorisation is granted free of charge, for all countries and for a period of 5 years.

## MEDIATION

In the event of a dispute with one of our group's establishments, you can contact us in the following way:

- Send a letter by registered letter with acknowledgement of receipt to the manager of the village concerned - Send a copy of this letter to the customer service department at customerservice@yellohvillage.com or by post to YELLOH! VILLAGE - BP68 - 7 chemin du môle - 30220 AIGUES MORTES

If you are not satisfied with the answer, you have the possibility to contact the CM2C Mediation Centre, after a period of one month following the sending of these letters/ emails. You must submit a file online on the following website <https://ec.europa.eu/> or by post: CM2C - 14 rue Saint Jean 75017 PARIS - FRANCE.

## RESPONSIBILITY OF THE VILLAGE

The client expressly acknowledges that the village cannot be held responsible for the communication by its partners or by any third party of false information that may be mentioned in their brochure or their website, in particular presentation photos, qualifications, activities, leisure activities, services and dates of operation.

All photos and texts used in the brochure or on the websites are non-contractual. They are for information purposes only. It may happen that some of the activities and facilities proposed and indicated in the description in the brochure may be removed, notably for climatic reasons or in the event of force majeure, as defined by the French courts.

## DATA-PROCESSING AND LIBERTIES

The information you provide us with when you place your booking will not be passed on to any third party. This information shall be considered confidential by the Village and by Yelloh! Village. It shall only be used by the internal services of the Village and Yelloh! Village, for the processing of your booking and to strengthen and personalise communication and the services reserved for customers of the Village and Yelloh! Village, according to your centres of interest.

In accordance with the French Data Protection Act of 6 January 1978, you have the right to access, rectify and oppose any personal data concerning you. To do so, simply send a request by post to the Village, indicating your surname, first name and address.





## LEISURE AND SERVICES

### Recreational activities are included



- 850 m² heated lagoon swimming pool • water playground • Water slides are reserved for those over 1m20 (3ft 11in) • Balneo area with 3 heated outdoor pools (reserved for persons with a pass in July and August, aged over 16, mornings reserved for naturists) Swimming costume/trunks are compulsory, shorts are forbidden in all aquatic areas
- Heated indoor swimming pool (for small children under 4 accompanied by a parent, or aquagym)

Tourist information point • Daily activities for adults and children • Disco • Satellite television • Table tennis • 2 Tennis courts • 2 multisport pitches • Beach volleyball • Petanque • Fitness • Step • Aquagym • Aerobics • Cycling • Toddler play house • Games area



## YELLOH! VILLAGE LE SERIGNAN PLAGE

Tél : + 33 (0)4 67 32 35 33

Fax : + 33 (0)4 67 32 68 39

[www.leserignanplage.com](http://www.leserignanplage.com)

E-mail : [info@leserignanplage.com](mailto:info@leserignanplage.com)

### Services

- Restaurants, bars • Bakery • Butcher
- Fish shop • Hairdresser • Casino supermarket (baby items available) • Take away, pâtisserie, pizza • Souvenir and gift shop • Newsagent (international papers) • Ice cream stand • Launderette: washing machines and tumble dryers • Cash dispenser • Photocopy machine, fax machine • Bicycle hire • Massage • wireless internet access • Arcade • Market with crafts and local products (01/07 - 31/08) • Pub (01/07 - 31/08)



### Wifi

Free Wifi at the bar for 20 min per day and available throughout the campsite for a fee. Included in the PREMIUM accommodations (4 connexions) and the campsite pitches (1 connexion)